

## OPERATION PROCEDURE

### 1. Test procedure for fingerstick whole blood

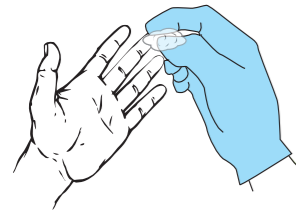

A. Wash hands and wipe the fingertip to be lanced with an alcohol prep pad.

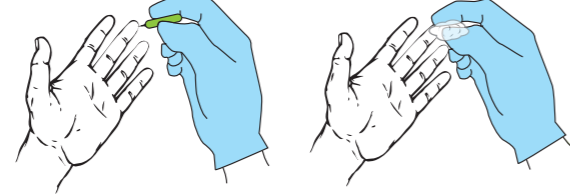

B. Prick the lateral side of fingertip with a lancet. Wipe off the first drop of blood with a cotton swab/ball.

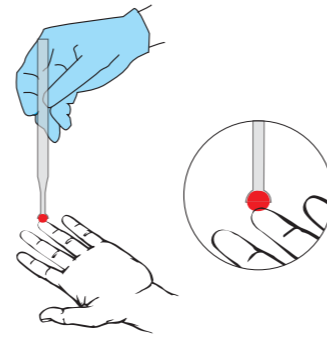

C. Dip the circular end of the inverted cup into the blood specimen (5µL).

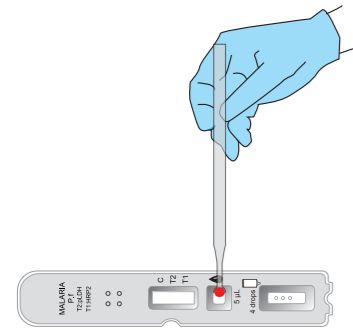

D. Place the circular end of the inverted cup into the sample well.

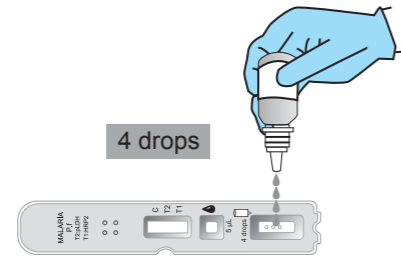

E. Add 4 drops (about 100µL) of buffer into the buffer well vertically and start timing.



15-30 mins

### 2. Test procedure for venous whole blood

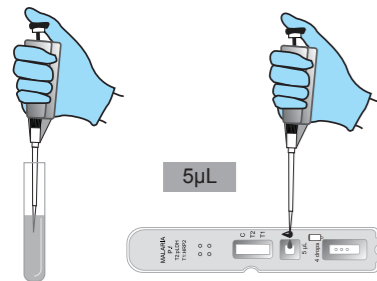

A. Take 5µL venous whole blood specimen with a pipette and drop it into the center of the sample well vertically.

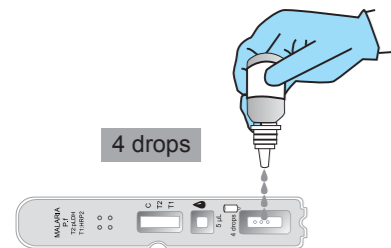

B. Add 4 drops (about 100µL) of buffer into the buffer well vertically, and start timing.

Lines that you see	Picture	Read and Interpretation of Results
No line at 'C' (control)		<b>Result: Invalid.</b> Action: Take a new cassette and repeat the test.
Line at 'C' and No other line		<b>Result: Negative.</b> Action: No
Line at 'C' and at 'T1' and/or 'T2'		<b>Result: Positive.</b> 1. Line at 'C' , 'T1' and 'T2' indicates positive for P.f HRP2 and P.f pLDH. 2. Line at 'C' and 'T1' indicates positive for P.f HRP2. 3. Line at 'C' and 'T2' indicates positive for P.f pLDH. Note: Line intensity may vary from faint to strong intensity. Consider a faint test line as a positive result. Action: No



## Kwiq Test HIV 1/2 Serum/Plasma/Whole Blood (Professional Use)

25 Tests



Saving Lives

